



Date _____ Project _____

Notes _____

STATIC WHITE MICRO RIBBONLYTE 4.5

We've introduced our Micro RibbonLyte for creating unique visual effects and precision lighting for tight spaces. It's designed to fit into our new AS7, AR7, AS9, and AR9 channels. At 4.5 W/ft (14.7 W/m), the IP20 and IP65 versions of this tape are only 0.20 inches (5 mm) wide.

- 4.5 W/ft (14.7 W/m)
- Create a custom fixture with our channels
- 6 white color temperatures
- 90+ CRI
- 2-Step MacAdam's ellipse binning



Applications:

- | | | |
|---------------|---------------|-------------|
| Commercial | Hospitality | Residential |
| Entertainment | Museums | Retail |
| Healthcare | Public Spaces | |

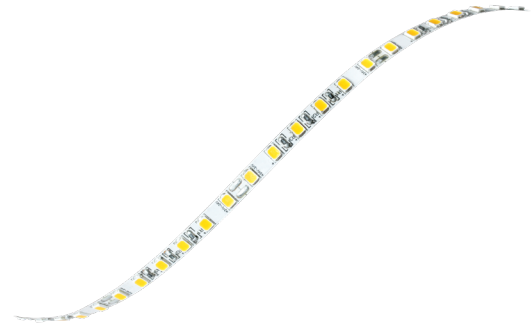

ORDERING GUIDE

Category	CRI	Ribbon Type & IP Rating	Wattage & Color	
RB	90			
RB - RIBBONLYTE	90 - 90+ CRI Static White	SWMC20 - Micro Static White IP20 SWMC65 - Micro Static White IP65	4.518 - 4.5 W/ft 1800K 4.520 - 4.5 W/ft 2000K 4.522 - 4.5 W/ft 2200K 4.524 - 4.5 W/ft 2400K 4.527 - 4.5 W/ft 2700K	4.530 - 4.5 W/ft 3000K 4.535 - 4.5 W/ft 3500K 4.540 - 4.5 W/ft 4000K 4.560 - 4.5 W/ft 6000K

CONNECTION OPTIONS

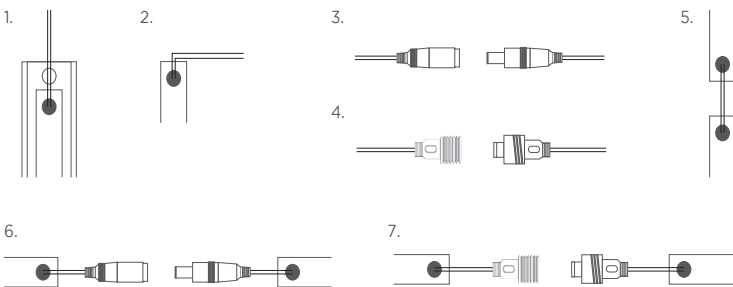



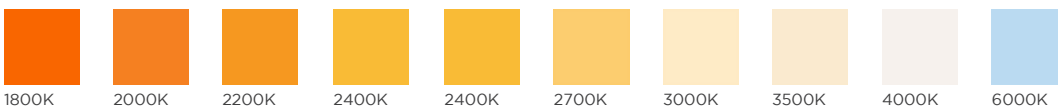

- 1 - Back Feed Hard Wire Through Channel
- 2 - Side Feed Hard Wire Connection
- 3 - IP20 Connector Input
- 4 - IP67 Connector Input
- 5 - Soldered Daisy-Chain
- 6 - Daisy Chain with IP20 Connectors
- 7 - Daisy Chain with IP67 Connectors

AVAILABLE COLOR TEMPERATURES



SPECIFICATIONS / DIAGRAM / USAGE GUIDELINES

STATIC WHITE MICRO RIBBONLYTE 4.5									
Operating Voltage	24 V								
Power Consumption	4.5 W/ft (14.8 W/m)								
Current (mA) - 24V	187.5 mA/ft (615 mA/m)								
LED Pitch	36 LEDs/ft (120 LEDs/m)								
Protection Rating	IP20, IP65								
Dimming/Control	ELV / MLV / 0-10 Volt / DMX / Lutron A-Series 1% dimming LED drivers / DALI								
Operating Temperature	-40° F to 158° F (-40° C to 70° C)								
Colors Temperatures	1800K	2000K	2200K	2400K	2700K	3000K	3500K	4000K	6000K
MacAdam's Ellipses (SDCM)	2-Step Binning								
Lumens	270 lm/ft (886 lm/m)	315 lm/ft (1033 lm/m)	345 lm/ft (1132 lm/m)	355 lm/ft (1164 lm/m)	393 lm/ft (1289 lm/m)	412 lm/ft (1351 lm/m)	388 lm/ft (1273 lm/m)	426 lm/ft (1397 lm/m)	418 lm/ft (1371 lm/m)
Binning Tolerance	+/- 100K								
LED Beam Angle	120°								
Lamp Life	50,000 Hrs								
Cutable Length	1.97 in (50 mm)								
CRI - All Color Temp.	90+ CRI								
Lumens/Watt	60 lm/W	70 lm/W	77 lm/W	80 lm/W	88 lm/W	93 lm/W	87 lm/W	97 lm/W	94 lm/W
Constant Voltage	✓								
Certifications	ETL, CE, RoHS								
Warranty	IP20: 6 years, IP65: 3 years								

24V DIMENSIONS	Top View	Side View	Dimensions
IP20	 <p>CUTTABLE EVERY: 1.97 in (50 mm)</p>		<p>Width 0.20 in (5 mm) Max Length* 28 ft (8.5 m) Height 0.06 in (1.45 mm)</p>
IP65	 <p>CUTTABLE EVERY: 1.97 in (50 mm)</p>		<p>Width 0.20 in (5 mm) Max Length* 28 ft (8.5 m) Height 0.1 in (2.5 mm)</p>

*Max length before additional power is introduced

USAGE GUIDELINES

- When installing this product take into account the surface temperature of the material this product is mounted to. Many building surfaces which are exposed to direct sunlight exceed the 70° C / 158° F maximum that our product is rated for. High risk locations like this should be avoided.
- Our IP65 can be used in wet, outdoor locations around swimming pools and spa tubs, but our products are not intended to be submerged in pools and fountains and do not carry UL676 certification to do so.
- Please refer to our RibbonLyte Proper Use Guide in our *Application Guide* for more information. Available for download at www.GENLEDBrands.com/Home/Acolyte
- Compatible with a wide variety of control products including the entire line of Lutron dimming systems.
- For use with GENLED Acolyte[®] drivers, 0-10V dimming modules and interface controllers (DMXINF models).
- Use with non-GENLED Acolyte[®] supplied Triac, MLV or ELV drivers is not supported or warranted.
- Due to the nature of the product, RibbonLyte cuttable lengths are generally longer or shorter than the customer requested length. Unless specified, RibbonLyte is factory cut at the shorter cuttable point.
- We reserve the right to make changes to product lineup, specifications, design and finishes at any time without notice.

GENLED Acolyte[®] does not warrant or represent that the information is free from errors or omission. The information may change without notice and GENLED Acolyte[®] is not in any way liable for the accuracy of any information printed and stored or in any way interpreted or used.

CHANNEL COMPATIBILITY / CHANNEL OPTIONS

	IP20/IP65	IP68
AS7	✓	✓
AR7	✓	✓
AS9	✓	
AR9	✓	

CHANNEL OPTIONS

LENS OPTIONS: M - Milky

SURFACE MOUNTED CHANNELS



AS7
M

AS9
M

RECESSED CHANNELS



AR7
M

AR9
M

WIRING DIAGRAMS

0-10V

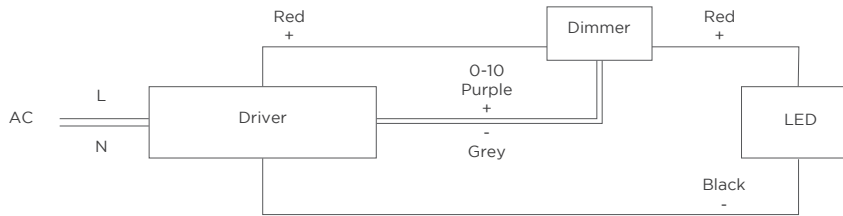

MAGNETIC + ELV

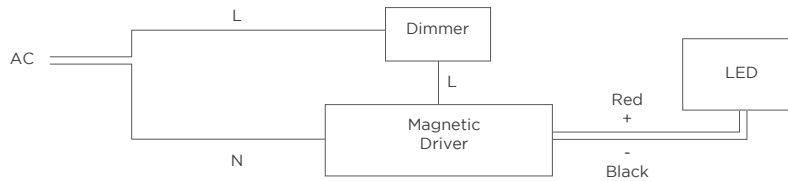

DMX

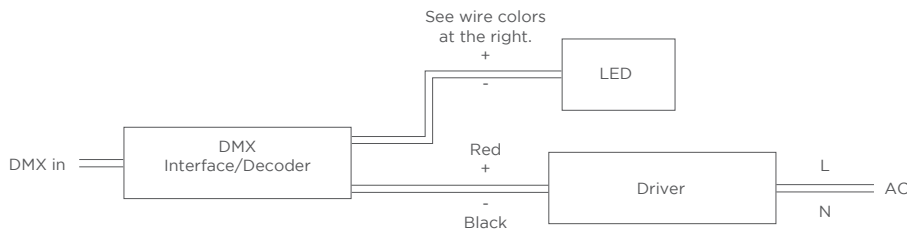

WIRE COLORS PER RIBBONLYTE COLOR

STATIC WHITE MICRO
Red Wire (+) Positive
Black Wire (-) Negative

DISCLAIMER

When installing this product take into account the surface temperature of the material this product is mounted to. Many building surfaces which are exposed to direct sunlight exceed the 70°C/158°F maximum that our product is rated for. High risk locations like this should be avoided.