

### STATIC WHITE MICRO RIBBONLYTE 3.0

We've introduced Micro RibbonLyte for creating unique visual effects and precision lighting for tight spaces. It's designed to fit into our new AS7, AR7, AS9, and AR9 channels. In 3.0 W/ft (9.80 W/m), the IP20 and IP65 versions of this tape are only 0.20 inches (5 mm) wide.

- 3.0 W/ft (9.8 W/m)
- 0.20 inch width (5 mm)
- Fits in 0.30 inch wide channel (7.60 mm)
- 6 color temperatures of white
- 90+ CRI
- 2-Step MacAdam's ellipse binning



#### Applications:

Commercial	Hospitality	Residential
Entertainment	Museums	Retail
Healthcare	Public Spaces	

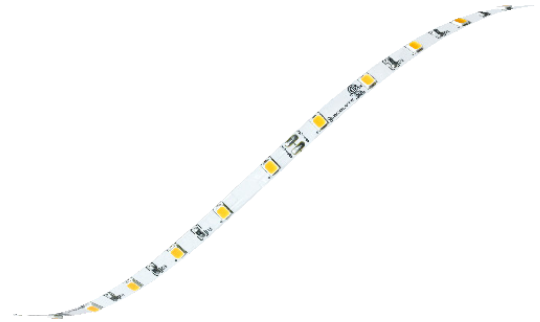

### ORDERING GUIDE

Category	CRI	Ribbon Type & IP Rating	Wattage & Color	
RB	90			
RB - RIBBONLYTE	90 - 90+ CRI Static White	<b>SWMC20</b> - Micro Static White IP20	<b>3.018</b> - 3.0 W/ft 1800K (IP20 Only)	<b>3.030</b> - 3.0 W/ft 3000K
		<b>SWMC65</b> - Micro Static White IP65	<b>3.020</b> - 3.0 W/ft 2000K (IP20 Only)	<b>3.035</b> - 3.0 W/ft 3500K
			<b>3.022</b> - 3.0 W/ft 2200K (IP20 Only)	<b>3.040</b> - 3.0 W/ft 4000K
			<b>3.024</b> - 3.0 W/ft 2400K	<b>3.060</b> - 3.0 W/ft 6000K
			<b>3.027</b> - 3.0 W/ft 2700K	

### CONNECTION OPTIONS

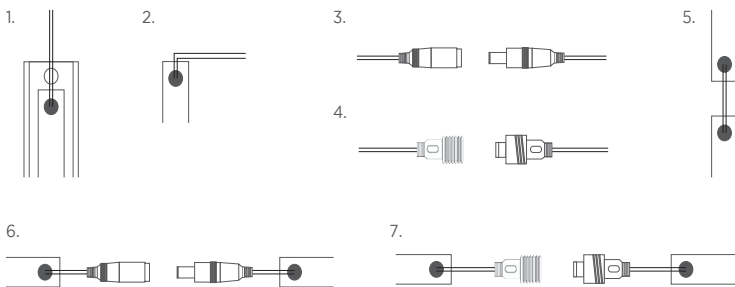



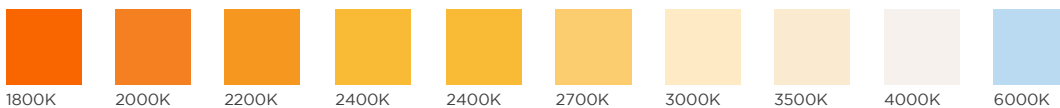

- 1 - Back Feed Hard Wire Through Channel
- 2 - Side Feed Hard Wire Connection
- 3 - IP20 Connector Input
- 4 - IP67 Connector Input
- 5 - Soldered Daisy-Chain
- 6 - Daisy Chain with IP20 Connectors
- 7 - Daisy Chain with IP67 Connectors

### AVAILABLE COLOR TEMPERATURES

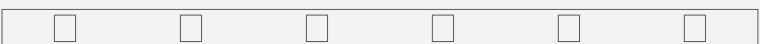

SPECIFICATIONS / DIAGRAM / USAGE GUIDELINES

STATIC WHITE MICRO RIBBONLYTE 3.0									
Operating Voltage	24 V								
Power Consumption	3.0 W/ft (9.84 W/m)								
Current (mA) - 24V	125 mA/ft (410 mA/m)								
LED Pitch	18 LEDs/ft (60 LEDs/m)								
Protection Rating	IP20, IP65								
Dimming/Control	ELV / MLV / 0-10 Volt / DMX / Lutron A-Series 1% dimming LED drivers / DALI								
Operating Temperature	-40° F to 158° F (-40° C to 70° C)								
MacAdam's Ellipses (SDCM)	2-Step Binning								
Colors	1800K	2000K	2200K	2400K	2700K	3000K	3500K	4000K	6000K
Lumens	177 lm/ft (581 lm/m)	203 lm/ft (666 lm/m)	225 lm/ft (738 lm/m)	237 lm/ft (777 lm/m)	270 lm/ft (886 lm/m)	282 lm/ft (925 lm/m)	301 lm/ft (987 lm/m)	291 lm/ft (955 lm/m)	279 lm/ft (915 lm/m)
Binning Tolerance	+/- 100K								
LED Beam Angle	120°								
Lamp Life	50,000 Hrs								
Cutable Length	3.94 in (100 mm)								
CRI - All Color Temp.	90+ CRI								
Lumens / Watt	59 lm/W	68 lm/W	75 lm/W	79 lm/W	90 lm/W	94 lm/W	98 lm/W	97 lm/W	93 lm/W
Constant Voltage	✓								
Certifications	ETL, CE, RoHS								
Warranty	IP20: 6 years, IP65: 3 years								

24V DIMENSIONS	Top View	Side View	Dimensions
IP20	 <p>CUTTABLE EVERY: 3.94in (100 mm)</p>		<p>Width 0.20 in (5 mm) Max Length* 28 ft (8.5 m) Height 0.06 in (1.45 mm)</p>
IP65	 <p>CUTTABLE EVERY: 3.94 in (100 mm)</p>		<p>Width 0.20 in (5 mm) Max Length* 28 ft (8.5 m) Height 0.1 in (2.5 mm)</p>

\*Max length before additional power is introduced

USAGE GUIDELINES

- When installing this product take into account the surface temperature of the material this product is mounted to. Many building surfaces which are exposed to direct sunlight exceed the 70° C / 158° F maximum that our product is rated for. High risk locations like this should be avoided.
- Our IP65 can be used in wet, outdoor locations around swimming pools and spa tubs, but our products are not intended to be submerged in pools and fountains and do not carry UL676 certification to do so.
- Please refer to our RibbonLyte Proper Use Guide in our *Application Guide* for more information. Available for download at [www.GENLEDBrands.com/Home/Acolyte](http://www.GENLEDBrands.com/Home/Acolyte)
- Compatible with a wide variety of control products including the entire line of Lutron dimming systems.
- For use with GENLED Acolyte<sup>®</sup> drivers, 0-10V dimming modules and interface controllers (DMXINF models).
- Use with non-GENLED Acolyte<sup>®</sup> supplied Triac, MLV or ELV drivers is not supported or warranted.
- Due to the nature of the product, RibbonLyte cuttable lengths are generally longer or shorter than the customer requested length. Unless specified, RibbonLyte is factory cut at the shorter cuttable point.
- We reserve the right to make changes to product lineup, specifications, design and finishes at any time without notice.

GENLED Acolyte<sup>®</sup> does not warrant or represent that the information is free from errors or omission. The information may change without notice and GENLED Acolyte<sup>®</sup> is not in any way liable for the accuracy of any information printed and stored or in any way interpreted or used.

CHANNEL COMPATIBILITY / CHANNEL OPTIONS

	IP20/IP65	IP68
AS7	✓	✓
AR7	✓	✓
AS9	✓	
AR9	✓	

CHANNEL OPTIONS

LENS OPTIONS: M - Milky

SURFACE MOUNTED CHANNELS



AS7  
M

AS9  
M

RECESSED CHANNELS



AR7  
M

AR9  
M

WIRING DIAGRAMS

O-10V

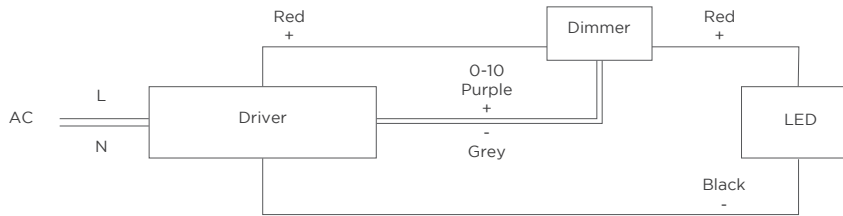

MAGNETIC + ELV

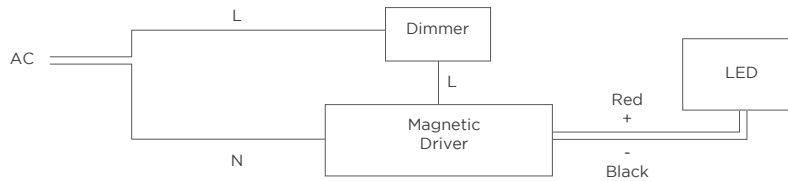

DMX

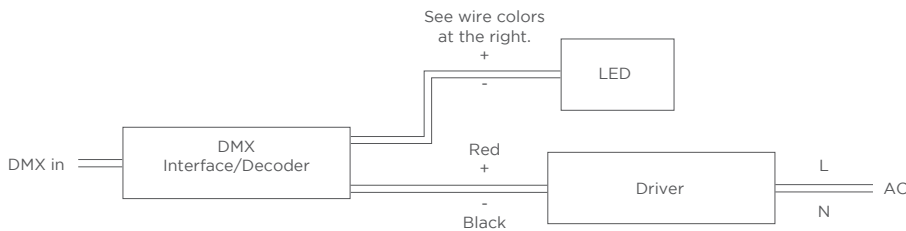

WIRE COLORS PER RIBBONLYTE COLOR

STATIC WHITE MICRO  
Red Wire (+) Positive  
Black Wire (-) Negative

DISCLAIMER

When installing this product take into account the surface temperature of the material this product is mounted to. Many building surfaces which are exposed to direct sunlight exceed the 70°C/158°F maximum that our product is rated for. High risk locations like this should be avoided.

REV.13SEP2019